

Autodesk Docs://FL\_02483\_Pompano Beach FSU\_2021.11\_REI/02483\_Pompano Beach FSU\_ARC.nt  
5/9/2023 8:45:47 AM  
02483-G-003-LIFE SAFETY PLAN

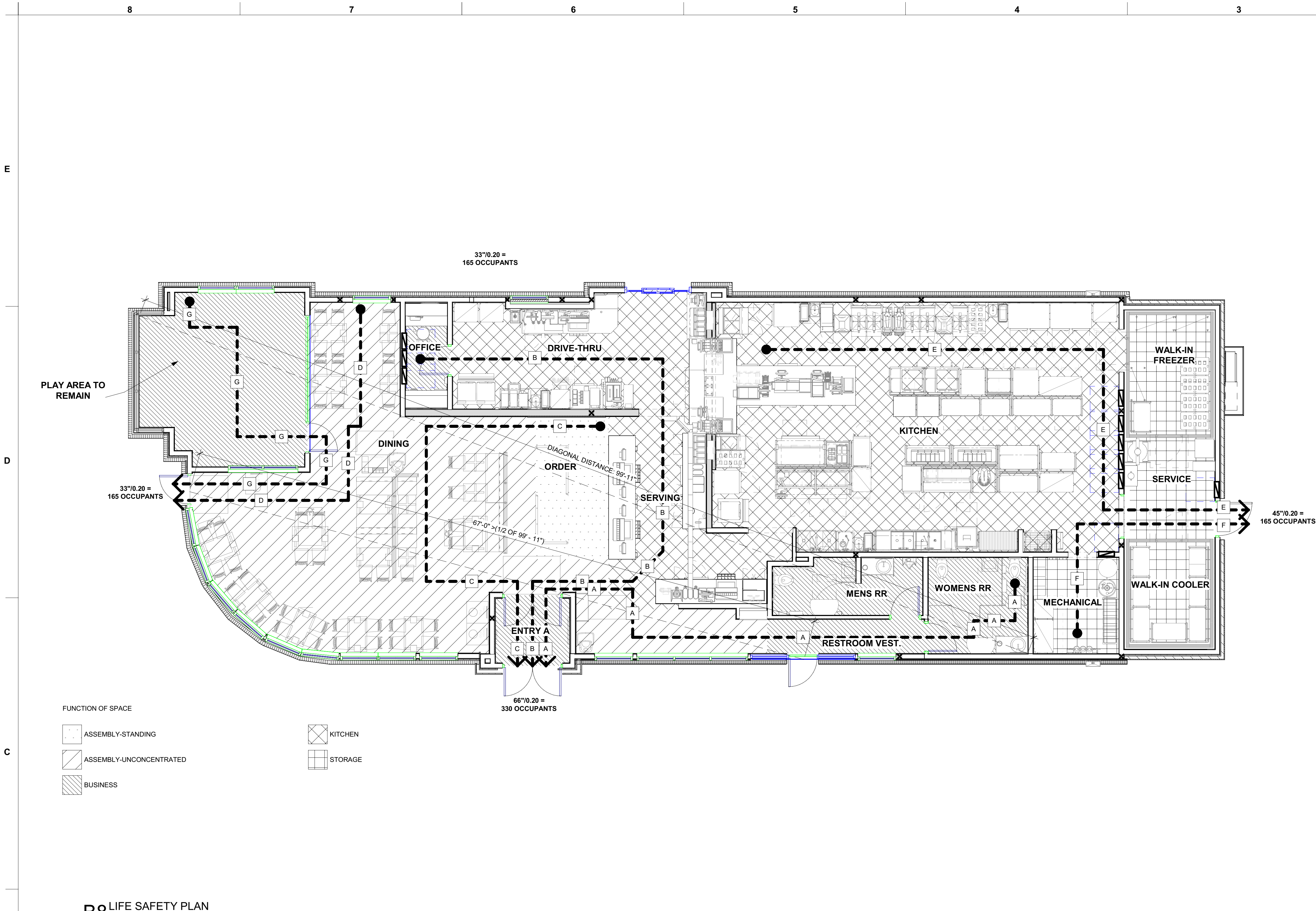

B8 LIFE SAFETY PLAN  
3/16" = 1'-0"

#### LIFE SAFETY PLAN LEGEND

- N.T.S.
- FE-1 10# CLASS K FIRE EXTINGUISHER ON WALL BRACKET. PROVIDE WITHIN 30 FEET MAX. TRAVEL DISTANCE IN KITCHEN
  - FE-2 10# CLASS ABC FIRE EXTINGUISHER ON WALL BRACKET. PROVIDE WITHIN 75 FEET MAX. TRAVEL DISTANCE
  - EMERGENCY LIGHTING SEE ELECTRICAL
  - MAX DISTANCE OF TRAVEL (FBC): 200'-0"

#### FIRE CODE NOTES

- SPRINKLER SYSTEM NOT REQUIRED BY LOCAL JURISDICTION.
- PROVIDE HOOD SUPPRESSION SYSTEM AS SHOWN ON MECHANICAL DRAWINGS.
- PROVIDE FIRE ALARM SYSTEM AS REQUIRED BY CODE OR JURISDICTION.
- PROVIDE GLASS TYPES AS SHOWN ON EXTERIOR AND INTERIOR ELEVATIONS.
- PROVIDE #10 ABC GENERAL PURPOSE FIRE EXTINGUISHERS THROUGHOUT BUILDING. QUANTITIES AND LOCATIONS PER LOCAL JURISDICTION.
- PROVIDE CLASS K FIRE EXTINGUISHERS IN KITCHEN AREAS ARE REQUIRED BY CODE.

#### BUILDING CODE NOTES

- PROVIDE FIREBLOCKING WITHIN CONCEALED SPACES PER LOCAL REQUIREMENTS.
- PROVIDE DRAFTSTOPPING IN ATTIC AS SHOWN ON REFLECTED CEILING PLAN.
- PROVIDE THERMAL AND SOUND INSULATION WITH FIRE CLASSIFICATIONS AS INDICATED IN SPECS.
- PROVIDE ROOFING MATERIALS WITH FIRE CLASSIFICATIONS AS INDICATED IN SPECS.
- PROVIDE CEILING FINISHES WITH FIRE CLASSIFICATIONS AS INDICATED IN SPECS.
- OCCUPANT LOAD SIGN BY G.C.; PROVIDE 2"x8" BLACK SIGN WITH 1/2" WHITE HELVETICA LETTERS STATING MAXIMUM OCCUPANT LOAD AS INDICATED IN ARCH DRAWINGS.
- CHICK-FIL-A IS REQUIRING SPECIAL INSPECTIONS IN ACCORDANCE WITH CHAPTER 17 OF THE INTERNATIONAL BUILDING CODE.

#### PLUMBING FIXTURE COUNTS

TOTAL BUILDING OCCUPANT LOAD: 104

LOAD DISTRIBUTION: 50% MALE AND 50% FEMALE

DISTRIBUTION COUNT: 52 MALE AND 52 FEMALE

LAVATORIES PROVIDED REQUIRED (PER CHAPTER 4 IPC AND CHAPTER 29 IBC):

MALE LAVATORIES: 52 / 200 = 1  
FEMALE LAVATORIES: 52 / 200 = 1

LAVATORIES PROVIDED:

MALE LAVATORIES: 1  
FEMALE LAVATORIES: 1

WATER CLOSETS REQUIRED (PER CHAPTER 4 IBC AND CHAPTER 29 IBC):

MALE WATER CLOSETS: 52 / 75 = 1  
FEMALE WATER CLOSETS: 52 / 75 = 1

WATER CLOSETS PROVIDED:

MALE WATER CLOSETS: 1 WATER CLOSETS  
FEMALE WATER CLOSETS: 1 URINALS  
2 WATER CLOSETS

#### EGRESS

- REQUIRED WIDTH OF EGRESS 31.8"
  - WIDTH OF EGRESS PROVIDED
- EXIT #1 = 69"  
EXIT #2 = 33"  
EXIT #3 = 33" (STAFF ONLY)  
EXIT #4 = 45" (STAFF ONLY)  
TOTAL: 180" TOTAL

EGRESS PATH	
EGRESS PATH	EGRESS DISTANCE
A	68'-3"
B	69'-8"
C	53'-1"
D	39'-8"
E	67'-7"
F	29'-6"
G	49'-8"

MAX DISTANCE OF TRAVEL (FBC): 200'-0"

#### PROJECT SUMMARY

THIS PROJECT CONSISTS OF A REMODEL TO AN EXISTING CHICK-FIL-A RESTAURANT AND ## SF REAR ADDITION, ## SF DRIVE-THRU EXPANSION, NEW CANOPIES, NEW REFUSE ENCLOSURE AND STORAGE.

#### APPLICABLE CODES & STANDARDS

BUILDING:	FLORIDA BUILDING CODE, BUILDING, 7TH EDITION (2020)
FIRE / LIFE SAFETY:	FLORIDA FIRE PREVENTION CODE, 7TH EDITION (2020) NFPA 101 - LIFE SAFETY CODE - 2018 EDITION NFPA 72, NATIONAL FIRE ALARM AND SIGNALING CODE - 2016 EDITION NFPA 96 - STANDARD FOR COMMERCIAL COOKING OPERATIONS - 2017 EDITION CHAPTER 120-3-3 RULES AND REGULATIONS FOR THE STATE MIN. FIRE SAFETY STANDARDS.
EXISTING BUILDING:	FLORIDA BUILDING CODE, EXISTING BUILDING, 7TH EDITION (2020)
PLUMBING:	FLORIDA BUILDING CODE, PLUMBING, 7TH EDITION (2020)
FUEL:	FLORIDA BUILDING CODE, FUEL GAS, 7TH EDITION (2020)
MECHANICAL:	FLORIDA BUILDING CODE, MECHANICAL, 7TH EDITION (2020)
ELECTRICAL:	NATIONAL ELECTRICAL CODE - (NFPA 70) 2017 EDITION
ENERGY:	ENERGY CONSERVATION, 7TH EDITION (2020)
ACCESSIBILITY:	FLORIDA BUILDING CODE, ACCESSIBILITY, 7TH EDITION (2020)

\* PLUS DCA AMENDMENTS TO THE INTERNATIONAL CODES

#### AUTHORITIES HAVING JURISDICTION

BUILDING:	City of Pompano Beach, Building Department
FIRE / LIFE SAFETY:	Pompano Beach Fire Rescue

#### OCCUPANCY CLASSIFICATION

(LSC Chapter 6 Classification of Occupancy and Hazardous Contents)  
(F.B.C. Chapter 3 - Use and Occupancy Classification)

ASSEMBLY OCCUPANCY (LSC)  
ASSEMBLY GROUP A-2 (IBC)

#### CONSTRUCTION TYPE

(FBC Chapter 6 - Types of Construction)

BUILDING: TYPE VB CONSTRUCTION, NON-SPRINKLERED

#### FIRE RESISTANCE OF BLDG. ELEMENTS BY CONSTRUCTION TYPE

PRIMARY STRUCT. FRAME:	0 HOURS
BEARING WALLS - EXT:	0 HOURS
BEARING WALLS - INT:	0 HOURS
NONBEARING WALLS - EXT:	SEE TABLE 602
NONBEARING WALLS - INT:	0 HOURS
FLOOR CONSTRUCTION:	0 HOURS
ROOF CONSTRUCTION:	0 HOUR
CORRIDORS:	NO RATING PER LSC SECTION 12.3.6 EXCEPTION (1)
EXIT STAIRS:	NOT APPLICABLE: NO STAIRS ARE PROVIDED FOR THIS PROJECT.
FLOOR OPENINGS / SHAFTS:	NOT APPLICABLE: NO FLOOR OPENINGS OR SHAFTS ARE BEING PROVIDED FOR THIS PROJECT.

#### BUILDING HEIGHT BY CONSTRUCTION TYPE

(F.B.C. Chapter 5 - General Building Heights and Areas)

ALLOWABLE HEIGHT:	1 STORY / 400 FT.
ACTUAL BUILDING HEIGHT:	1 STORY / 23' - 2"

#### BUILDING AREA BY CONSTRUCTION TYPE

(F.B.C. Chapter 5 - General Building Heights and Areas)

ALLOWABLE BUILDING AREA:	6,000 SF
ACTUAL BUILDING AREA:	4,251 SF
NO HEIGHT OR AREA INCREASES ARE UTILIZED. THE BUILDING AREA, HEIGHT AND NUMBER OF STORIES ARE WITHIN THE LIMITATIONS OF THE IBC CHAPTER 5	

#### OPENING PROTECTIVES IN FIRE RESISTANT CONSTRUCTION

NOT APPLICABLE - NO FIRE RESISTANT CONSTRUCTION IS BEING PROVIDED IN THIS PROJECT.

#### INTERIOR FINISHES

CONSTRUCTION TYPE	FIRE RESISTANCE RATING
EXITS	CLASS A
EXIT ACCESS CORRIDORS	CLASS B
OTHER THAN EXITS	CLASS C
LOW HEIGHT PARTITIONS	CLASS C (SEE NOTE 1)
INTERIOR FLOOR FINISHES	CLASS II
GENERAL ASSEMBLY AREAS (>300)	CLASS B
ASSEMBLY AREAS (<300)	CLASS C

NOTES:  
1. PARTITIONS NOT EXCEEDING 60 INCHES AND IN LOCATIONS OTHER THAN EXITS

#### OCCUPANT LOADS

THE CALCULATED OCCUPANT LOAD RESULTS IN A TOTAL BUILDING POPULATION FOR EGRESS OF **104 PERSONS** AS INDICATED BELOW. REFER TO EGRESS CAPACITY TABLES BELOW FOR EGRESS BY FLOOR OR AREA. REFER TO THE LIFE SAFETY DRAWINGS FOR THE OCCUPANCY SCHEDULES.

OCCUPANT LOAD	PROVIDED EGRESS
TOTAL CAPACITY FOR EGRESS	104 PERSONS
	1,140 PERSONS

#### EGRESS CAPACITY

REFER TO THE LIFE SAFETY DRAWINGS FOR THE LOCATION AND CAPACITY OF ALL EGRESS COMPONENTS

EXITS	EXIT WIDTH - REQUIRED	EXIT WIDTH - PROVIDED
	104 PERSONS X 0.2' = 20.8 INCHES	180 INCHES

#### MINIMUM AISLE WIDTH

REFER TO THE SECTION 1029 FBC - SPECIFICALLY 1029.9.1

#### MINIMUM AISLE WIDTH

LESS THAN 50 OCCUPANTS = 36" CLEAR ON ONE SIDE OR BOTH  
LESS THAN 50 OCCUPANTS AND NOT PART OF AN ACCESSIBLE ROUTE = 30" CLEAR  
LESS THAN 15 OCCUPANTS = NOT PART OF ACCESSIBLE ROUTE

OCCUPANT LOAD SCHEDULE				
Name	Area	Occupancy	AREA PER OCCUPANT	TOTAL OCCUPANTS
ORDER	115 SF	ASSEMBLY-STANDING	7 SF	17
DINING	982 SF	ASSEMBLY-UNCONCENTRATED	15 SF	66
ENTRY A	54 SF	BUSINESS	150 SF	1
MENS RR	91 SF	BUSINESS	150 SF	1
OFFICE	50 SF	BUSINESS	150 SF	1
PLAY AREA TO REMAIN	282 SF	BUSINESS	150 SF	2
RESTROOM VEST.	59 SF	BUSINESS	150 SF	1
WOMENS RR	107 SF	BUSINESS	150 SF	1
DRIVE-THRU	308 SF	KITCHEN	200 SF	2
KITCHEN	1097 SF	KITCHEN	200 SF	6
SERVING	262 SF	KITCHEN	200 SF	2
MECHANICAL	92 SF	STORAGE	300 SF	1
SERVICE	93 SF	STORAGE	300 SF	1
WALK-IN COOLER	96 SF	STORAGE	300 SF	1
WALK-IN FREEZER	116 SF	STORAGE	300 SF	1
TOTAL OCCUPANTS				104

SEAT QUANTITY (SEE FURNITURE PLANS) : 66 PERSONS  
CALCULATED TOTAL OCCUPANT LOAD: 104 PERSONS



Chick-fil-A  
5200 Buffington Road  
Atlanta, Georgia  
30349-2998



www.cphcorp.com

A Full Service  
A & E Firm

Plans Prepared By :

CPH, Inc.

State of Georgia Licenses:

Engineer No. PEF006331

Surveyor No. LSF000870

Architect No. N/A

Landscape No. N/A

PROTOTYPICAL SET

NOT FOR  
REGULATORY  
APPROVAL,  
BIDDING, OR  
CONSTRUCTION

CHICK-FIL-A  
POMPAÑO BEACH

2250 N FEDERAL HWY  
POMPAÑO BEACH, FL 33062

FSR#02483

BUILDING TYPE / SIZE: S06-N  
RELEASE: 2022.05

#### REVISION SCHEDULE

NO. DATE DESCRIPTION

DESIGN DEVELOPMENT

CONSULTANT PROJECT # C29179  
PRINTED FOR DESIGN DEVELOPMENT  
DATE 02-06-23  
DRAWN BY CPH

Information contained on this drawing and in all digital files produced for above named project may not be reproduced in any manner without written or verbal consent from the project architect's representatives.

PROJECT SAFETY PLAN  
SHEET NUMBER: G-003

DRC

PZ23-12000022  
07/19/2023